

-  Cafeteria
-  Information
-  Elevator
-  Restrooms
-  Accessible
-  Gender Neutral

### LEVEL 1

- Arts/Communications/Social Sciences Division - **B1301**
- Art Gallery - **C1260**
- Athletic Department - **C2111**
- BOOKSTORE - **C1110**
- CAFETERIA - **C1131**
- Career Technologies Division - **A1410**
- CONFERENCE CENTER - **A Wing**
- Disability Services - **A1317**
- GYMNASIUM - **A0400**
- Health & Education Division - **B1222**
- Human Resources - **C1100**
- Jenkins Auditorium - **A1224**
- Lactation Room - **A1235**
- LIBRARY - **A1100**
- Marketing & Public Relations - **A1227**
- Math/Science/Business Division - **B1301**
- Media Services - **A1252**
- Public Computer Room - **A1345**
- Student Activities - **C1120**
- Student Lounge - **C1130**
- Testing & Tutoring Services - **A1300**
- THEATRE - **B1205**
- Wellness Center - **A1403**
- Workforce & Community Education Division - **C1210**

### LEVEL 2

- Administration - **C2160**
- Advising Lab - **C2110**
- Boardroom - **C2175**
- Business Office - **C2140**
- Career Center - **C2123**
- Financial Aid - **C2150**
- Foundation Development - **A2160**
- Information Technology - **B2324**
- Security/DeKalb County Sheriff's Office - **C2177**
- Student Outreach - **C2150**
- Student Services - **C2100**
- Teaching & Learning Center - **B2331**
- TRiO Student Support Services - **C2129**

Caukin Building

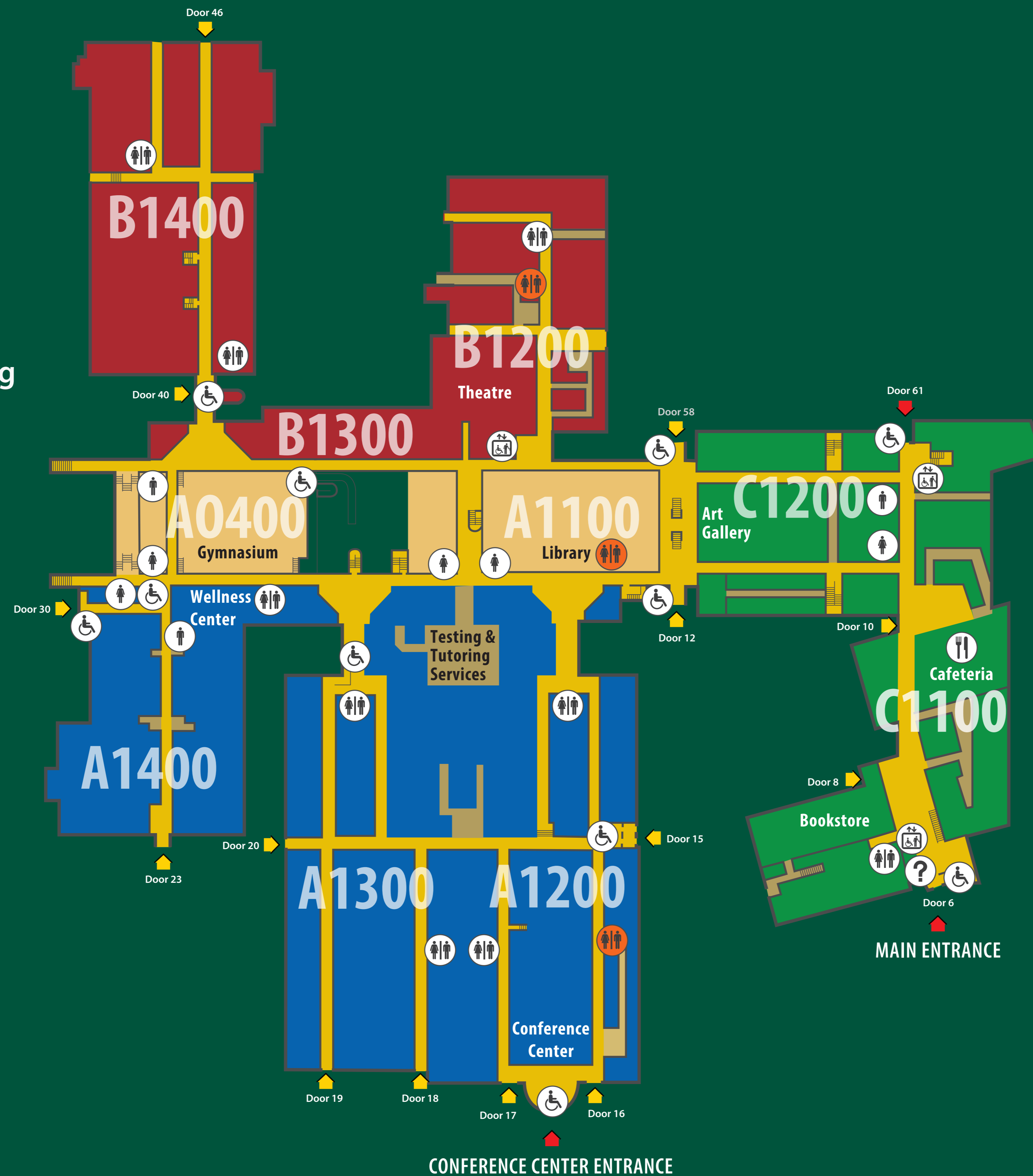

# LEVEL 1

CONFERENCE CENTER ENTRANCE

MAIN ENTRANCE



View our interactive map at  
[www.kish.edu/maps](http://www.kish.edu/maps)



Elevator



Restrooms

### LEVEL 1

Arts/Communications/Social Sciences Division - **B1301**

Art Gallery - **C1260**

Athletic Department - **C2111**

BOOKSTORE - **C1110**

CAFETERIA - **C1131**

Career Technologies Division - **A1410**

CONFERENCE CENTER - **A Wing**

Disability Services - **A1317**

GYMNASIUM - **A0400**

Health & Education Division - **B1222**

Human Resources - **C1100**

Jenkins Auditorium - **A1224**

Lactation Room - **A1235**

LIBRARY - **A1100**

Marketing & Public Relations - **A1227**

Math/Science/Business Division - **B1301**

Media Services - **A1252**

Public Computer Room - **A1345**

Student Activities - **C1120**

Student Lounge - **C1130**

Testing & Tutoring Services - **A1300**

THEATRE - **B1205**

Wellness Center - **A1403**

Workforce & Community Education Division - **C1210**

### LEVEL 2

Administration - **C2160**

Advising Lab - **C2110**

Boardroom - **C2175**

Business Office - **C2140**

Career Center - **C2123**

Financial Aid - **C2150**

Foundation Development - **A2160**

Information Technology - **B2324**

Security/DeKalb County Sheriff's Office - **C2177**

Student Outreach - **C2150**

Student Services - **C2100**

Teaching & Learning Center - **B2331**

TRiO Student Support Services - **C2129**



NORTH

# LEVEL 2

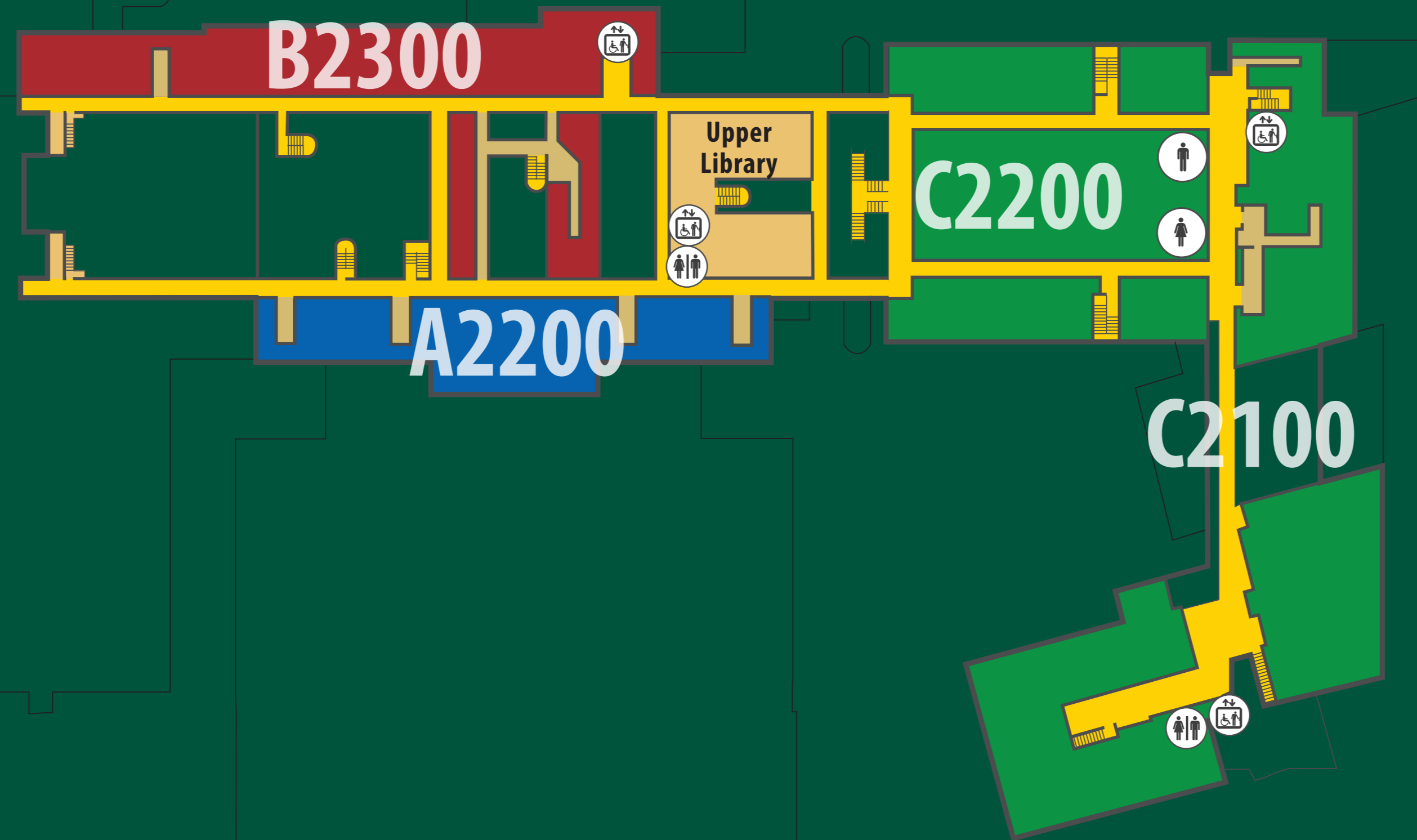

View our interactive map at [www.kish.edu/maps](http://www.kish.edu/maps)



# DISTRICT #523 MAP

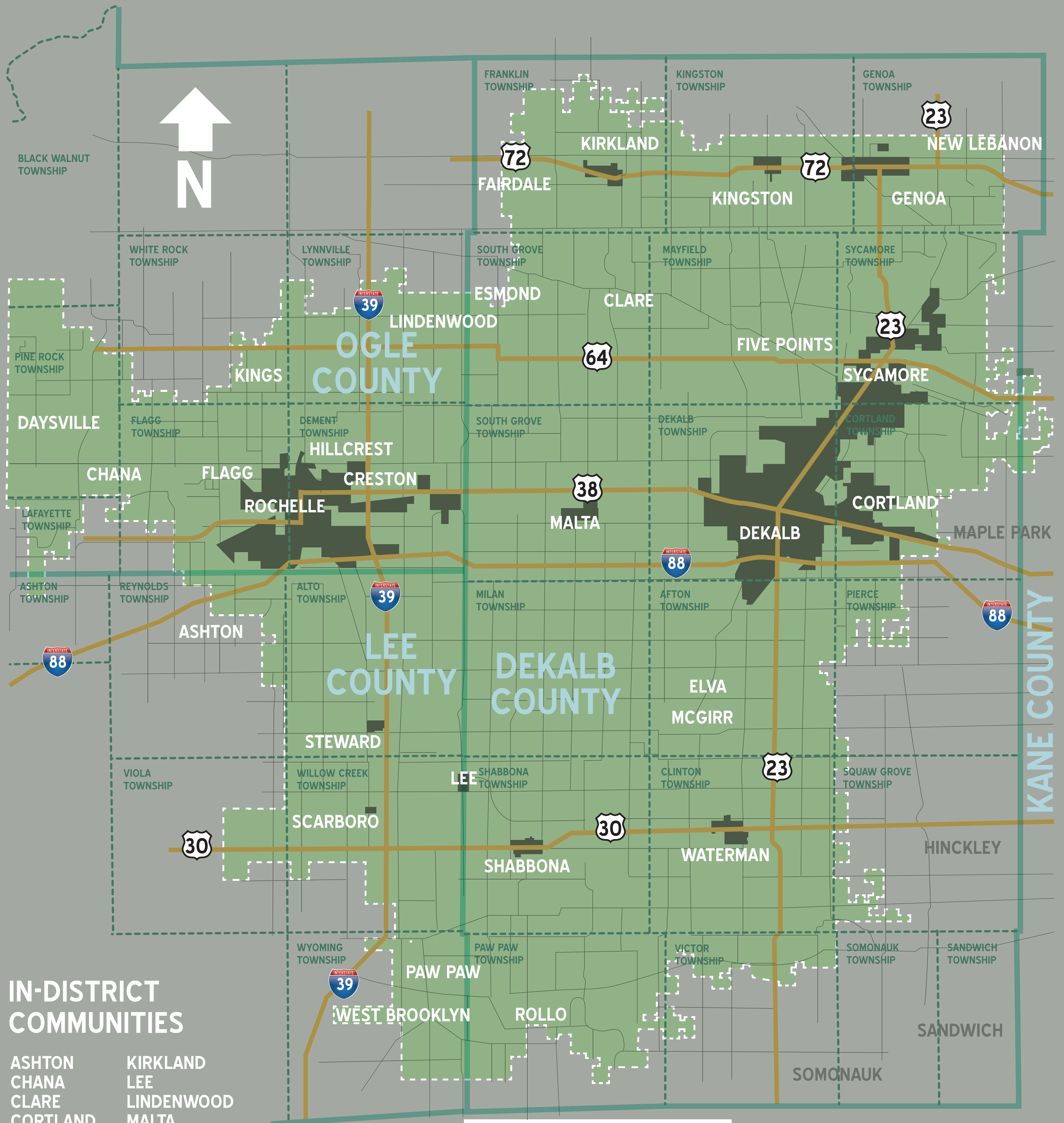

## IN-DISTRICT COMMUNITIES

- |             |               |
|-------------|---------------|
| ASHTON      | KIRKLAND      |
| CHANA       | LEE           |
| CLARE       | LINDENWOOD    |
| CORTLAND    | MALTA         |
| CRESTON     | MCGIRR        |
| DAYSVILLE   | NEW LEBANON   |
| DEKALB      | PAW PAW       |
| ELVA        | ROCHELLE      |
| ESMOND      | ROLLO         |
| FAIRDALE    | SCARBORO      |
| FIVE POINTS | SHABBONA      |
| FLAGG       | STEWARD       |
| GENOA       | SYCAMORE      |
| HILLCREST   | WATERMAN      |
| KINGS       | WEST BROOKLYN |
| KINGSTON    |               |

## LEGEND

- |  |                        |
|--|------------------------|
|  | DISTRICT #523 BOUNDARY |
|  | TOWNSHIP BOUNDARY      |
|  | COUNTY BOUNDARY        |
|  | MAJOR ROADWAYS         |
|  | MINOR ROADWAYS         |
|  | COMMUNITY LIMITS       |
|  | COMMUNITY NAMES        |
|  | TOWNSHIP NAMES         |
|  | COUNTY NAMES           |

## KISHWAUKEE COLLEGE

21193 MALTA ROAD  
 MALTA, ILLINOIS 60150  
 815-825-2086  
 TTY 815-825-9106  
 WWW.KISHWAUKEECOLLEGE.EDU