

Kishwaukee College

21193 Malta Road
 Malta, Illinois 60150
 815-825-2086
 TTY 815-825-9106
 www.kishwaukeecollege.edu

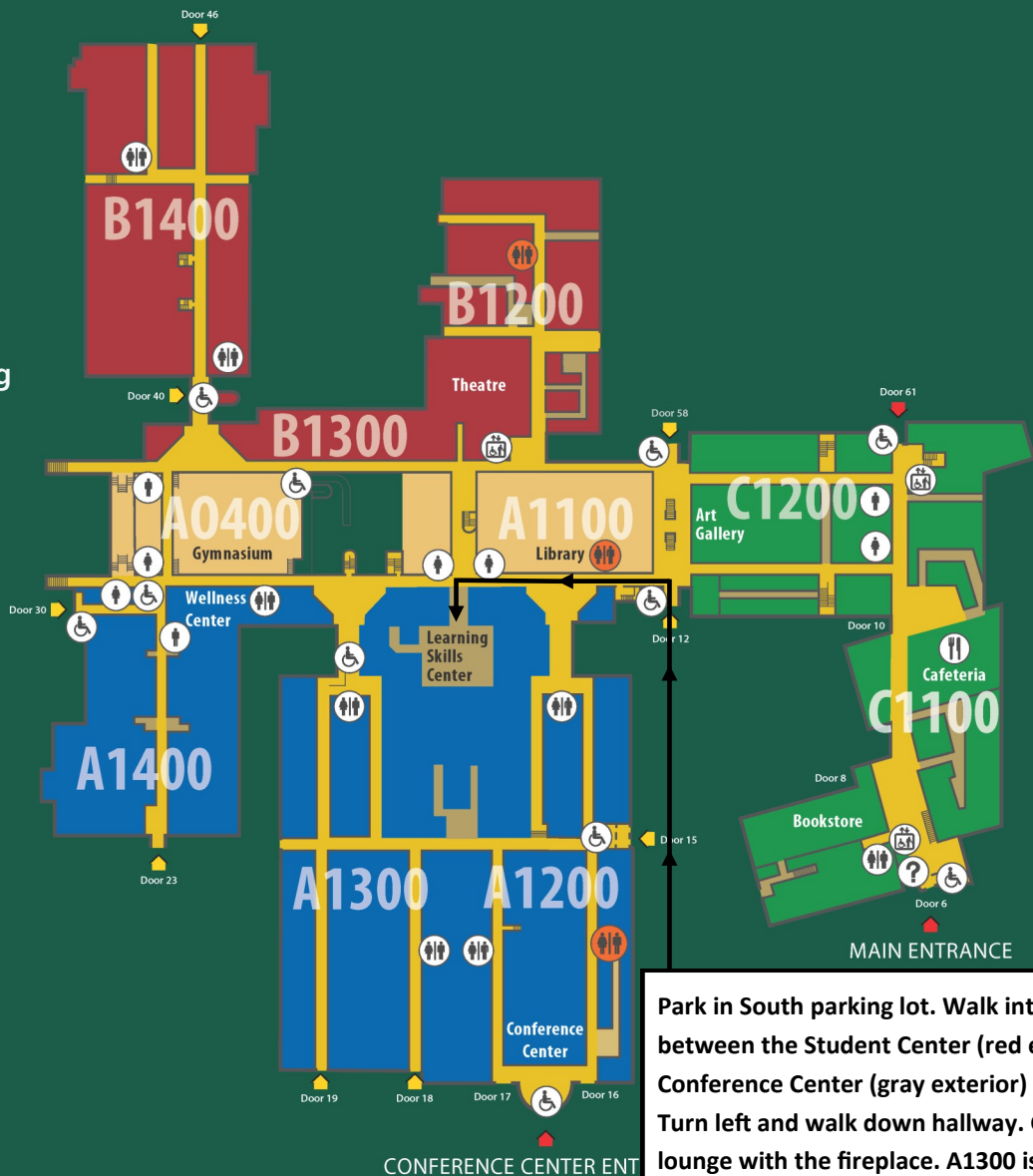

Caukin Building

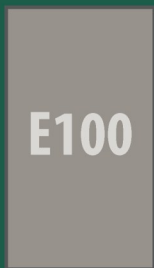

LEVEL 1

- Cafeteria
- Information
- Elevator
- Restrooms
- Accessible
- Gender Neutral

LEVEL 1

- Access, Equity & Diversity Center - **B0300**
- Adult Education & Transition Programs - **C1210**
- Arts/Communications/Social Sciences Division - **B1301**
- Art Gallery - **C1260**
- Assistive Resources/Disability Services - **A1317**
- Athletic Department - **A0409**
- BOOKSTORE - **C1110**
- CAFETERIA - **C1131**
- Career Technologies Division - **A1410**
- Center for Business Development & Continuing Ed. - **A1227**
- CONFERENCE CENTER - **A Wing**
- Foundation Development - **A1227**
- GYMNASIUM - **A0400**
- Health & Education Division - **B1222**
- Human Resources - **C1261**
- Information Technology - **A1345**
- Jenkins Auditorium - **A1224**
- Learning Skills Center - **A1300**
- LIBRARY - **A1100**
- Math/Science/Business Division - **B1301**
- Media Services - **A1252**
- New Student Connections - **C1100**
- Public Computer Room - **A1345**
- Student Activities - **C1120**
- Student Lounge - **C1130**
- THEATRE - **B1205**
- Wellness Center - **A1403**

LEVEL 2

- Administration - **C2160**
- Admissions, Registration & Records - **C2100**
- 75**
- C2140**
- C2123**
- Student Development - **C2110**
- Veterans Affairs - **C2150**
- Activeness - **C2160**
- Public Relations - **B2324**
- County Sheriff's Office - **C2177**

Park in South parking lot. Walk into the courtyard between the Student Center (red exterior) and Conference Center (gray exterior) to Door 12. Turn left and walk down hallway. Go past the lounge with the fireplace. A1300 is on the left.